



ECORADI

Instructions & installation manual



Voice Control



**NOT SUPPLIED
SMARTBOX**

**IF YOU HAVE ANY DIFFICULTY WITH
THIS PRODUCT, INSTEAD OF TAKING
IT BACK TO THE RETAILER, TRY:**

- 1. The instruction booklet**
- 2. Refer to haverland@haverland.co.uk**
- 3. Or call our helpline:
UK: 0330 365 1940**





INDEX

PAGE

4	1. CAUTION
6	2. INSTRUCTIONS FOR INSTALLATION
9	3. OPERATION
9	3.1 CONTROL PANEL
9	3.2 YOUR RADIATOR IS CONFIGURED!
11	3.3 FACTORY-SET PARAMETERS
11	3.4 OPERATING MODES
12	3.4.1 LEARNING MODE (factory activated)
13	3.4.2 SENSOR MODE
13	3.4.3 MANUAL MODE
13	3.5 ADJUSTING THE TEMPERATURE
14	3.6 COMFORT, ANTI-FROST AND ECONOMY TEMPERATURES
15	3.7 "OPEN WINDOW" FUNCTION
16	3.8 "KEYPAD LOCK" FUNCTION
16	3.9 STANDBY
17	3.10 ADJUSTING DAY AND TIME
18	3.11 OTHER INDICATIONS
18	3.11.1 HEATING ELEMENT ON INDICATOR
18	3.11.2 SENSOR INDICATOR ON
19	3.12 BATTERY
19	4. SMARTBOX (OPTIONAL)
19	4.1 SMARTBOX (OPTIONAL)
20	4.2 CONTROL "VIA APP"
20	4.2.1 HOW DO I CONFIGURE THE SMARTBOX WITH MY RADIATORS?
21	5. MAINTENANCE
21	6. GUARANTEE



1. CAUTION

- **Please read these instructions carefully.**

- To disconnect mains power from the radiator remove the plug from the wall socket, but **never pull on the cable.**

- Do not leave the mains cable in contact with the radiator when it is switched on.

- During operation, the radiator must be kept well away from combustible materials, such as curtains, carpets and furniture etc.

- **The warranty for the radiator does not cover any damage caused by not reading these instructions.**



WARNING: In order to avoid overheating, do not cover the heater.



- **WARNING:** If the mains power cable is damaged, it must be replaced by the manufacturer, with their after-sales service or similar qualified persons, in order to prevent any danger.



- **WARNING:** If the heater is to be installed in a bathroom, it must be positioned so that it cannot be touched by anybody in the bath or shower.



- **The installation should be carried out with consideration to the manufacturer's instructions and in accordance to the relevant National Wiring Regulations BS7671.**

- It is very important that radiator has a good Electric Earth connection.

- The radiator shall be installed so that its mains plug is always accessible.

- The radiator must not be installed below or in front of a mains socket.

- **This radiator cannot be surface-mounted with a wall. Safety distances shall always be respected.**



1. CAUTION

- **The radiator has a keyboard blockage option to prevent children from changing the programming.**

- This unit is not designed to be handled by persons (including children) with physical, sensorial or mental handicaps, with little experience or knowledge unless they are under the supervision of an adult responsible for their safety with the instructions on its use. Children shall always be supervised to ensure they do not play with the unit.

- Children under three shall be kept well away from the heater unless they are continually supervised.

- Children between three and eight shall only switch the unit off or on providing it is positioned or installed in its final operating location and be supervised or have received instructions on how to use the unit in a safe manner and understand the risks involved.

- Children between three and eight shall not plug in, adjust or clean the heater or carry out any maintenance operations.

- This unit may be used by children older than eight and by persons with physical, sensorial or mental handicaps, with little experience or knowledge, provided they have been duly trained and are supervised by an adult that understands the risks involved.

- Cleaning and maintenance shall be performed by adults not children. Children must not play with the unit.



- **WARNING: Certain parts of this product can become very hot and cause burns.** Special attention shall be paid when children and other vulnerable persons are present.

- Do not touch the external parts of the radiator when it is operating.

- It is quite normal that, with the first switch-on, the unit produces a “new” smell. Allow your heater to operate in a well-ventilated place for two or three hours.



2. INSTRUCTIONS FOR INSTALLATION

• Before the first switch on for the coming winter or when the heater has not been used for several days, the unit should be cleaned (follow the steps given in the “maintenance section”). This cleaning operation will avoid burning the accumulated dust and other remains.



- This radiator **CAN'T OPERATE** with external programmable controllers or any other exterior control device.
- **CAUTION:** Keep bags and other accessories well out of the reach of children.
- The convection effect, together with other ambient factors, can cause discolouring to metal surfaces and to plastics.
- Temperature differences can cause crackling and other noises in the unit. This does not indicate any failure in the radiator.
- When the radiator is disposed of, the requirements established by current legislation on waste processing and recycling shall be taken into account.



IMPORTANT

- It is important that the radiator **IS FIXED FIRMLY TO A SOLID AND LEVELLED WALL**.
- Make sure that there is a socket near the area where you are going to place it.
- Take out the wall pattern from the box to see the exact positions of the necessary drill holes.
- You must keep a minimum distance of 15 cm between the radiator and any object, wall or combustible material.

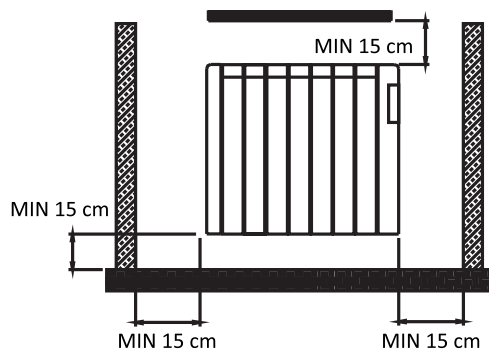



2. INSTRUCTIONS FOR INSTALLATION



IMPORTANT

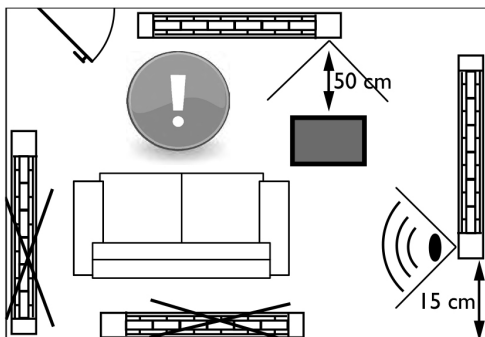

- Take into account the radiator location so that it can detect presence over the largest possible area of the room.

- The presence sensor will not detect any movement if the distance to the heater exceeds five metres.

- Remember that the sensor will detect the movement of pets.

- **DO NOT PLACE ANY OBJECTS IN FRONT OF OR ANYWHERE NEAR THE SENSOR.**

1

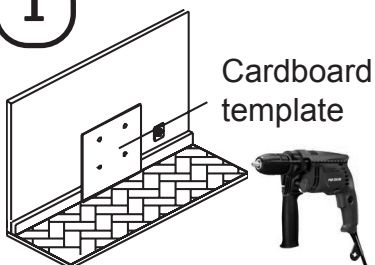

2

Place the screw
but don't
screw it fully.
(M. 6 x 40 mm)

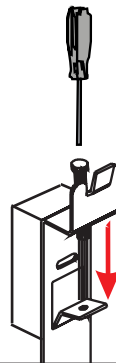

3

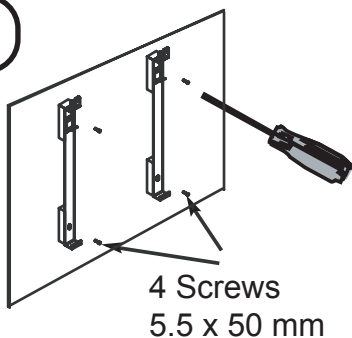

4

Place
the radiator





2. INSTRUCTIONS FOR INSTALLATION

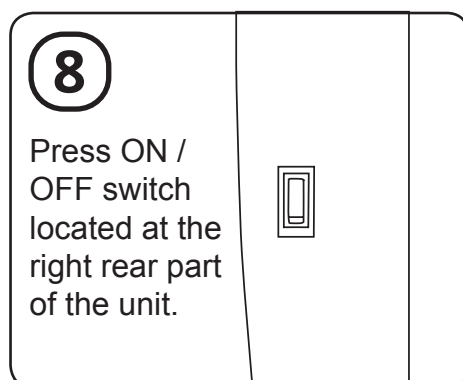
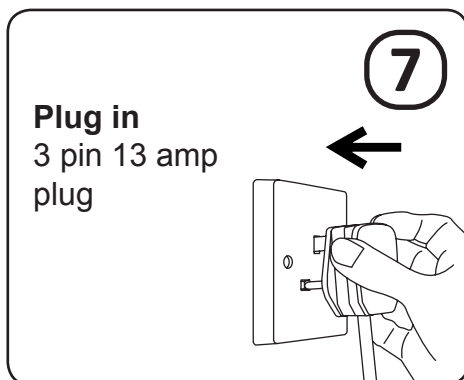
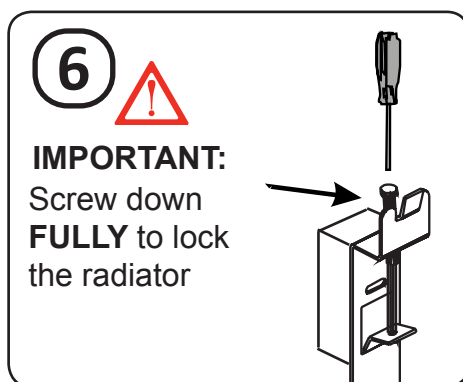
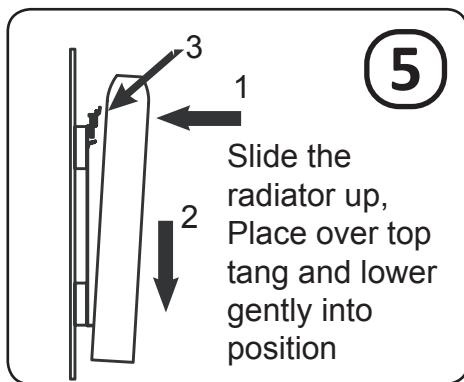

INFORMATION

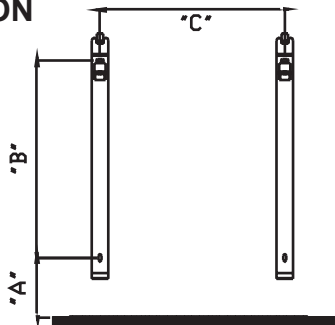

(W)	"A" (mm)	"B" (mm)	"C" (mm)
500	420	246	159
750	420	246	319
1000	420	246	478
1250	420	246	638
1500	420	246	638



3. OPERATION

3.1 CONTROL PANEL

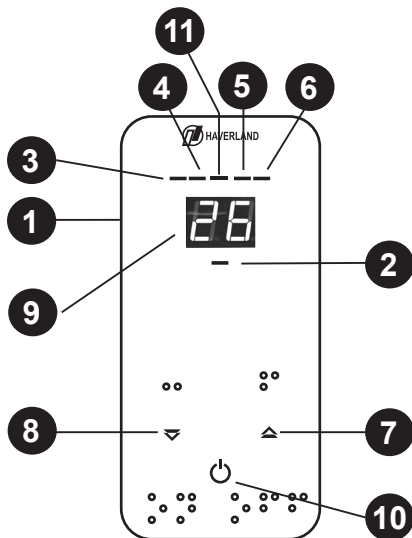

1. Panel control
2. Temperature indicator
 - **Red = Comfort**
 - **Blue = Anti-frost**
 - **Green = Economy**
3. Operating mode indicator:
 - Flashing = "Learning" mode
 - Fixed = Sensor mode
 - Off = Manual mode or "Forced" programming mode (via Smartbox App (available separately)).
4. "Forced" programming mode (via Smartbox App (available separately)).
5. Sensor indicator
6. Heating On
7. Increase
8. Decrease
9. Screen:
 - Ambient temperature
 - Selected temperature
 - Clock and day
10. Standby
11. "Open windows" indicator

3.2 YOUR RADIATOR IS CONFIGURED!

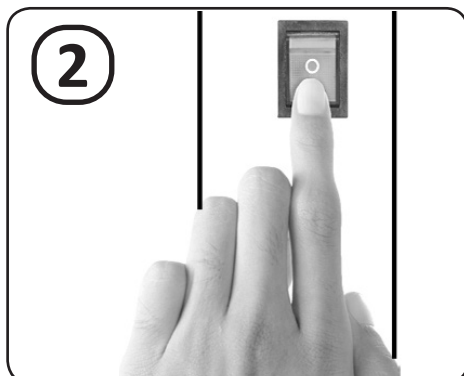
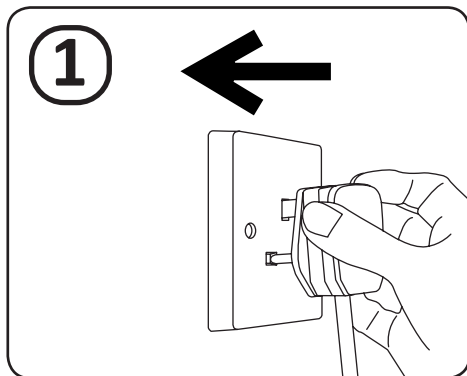



3. OPERATION

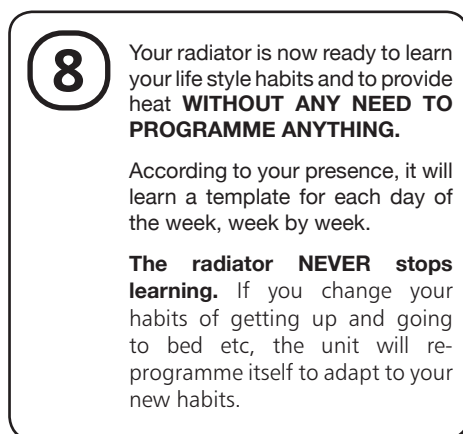
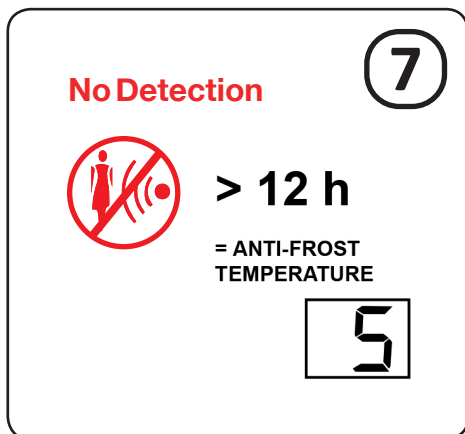
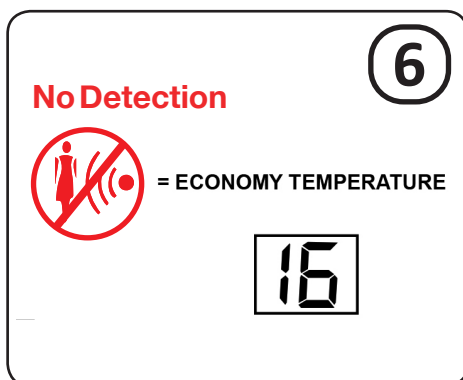
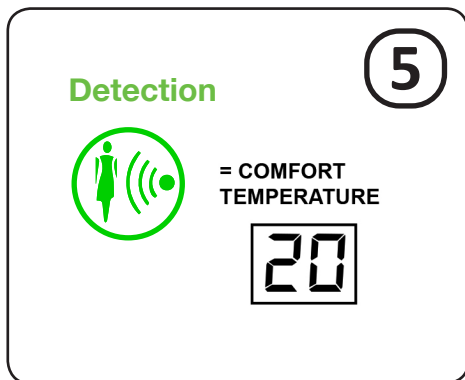
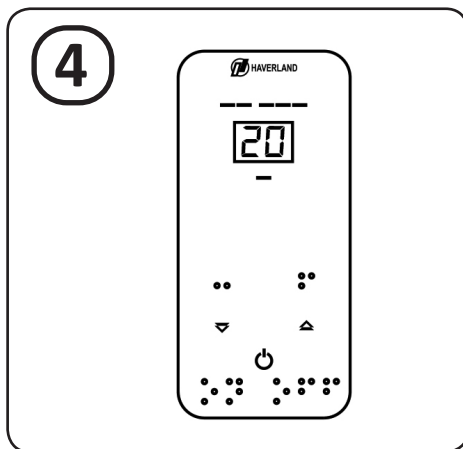
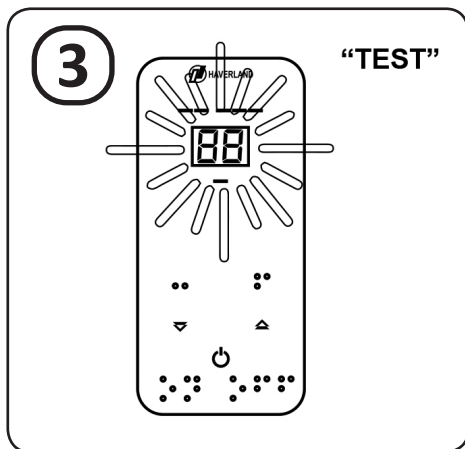



3. OPERATION

3.3 FACTORY-SET PARAMETERS



- 1) Clock and current day are factory set.
- 2) Comfort temperature = 20 °C.
- 3) Economy temperature = 16 °C
- 4) Activated operating mode = "Learning" mode.

3.4 OPERATING MODES

Your radiator incorporates four operating modes. The "learning" mode is activated at the factory.

To change the operating mode:

Simultaneously press  and  every time you want to change the operating mode.

Light indicator 3
will change:

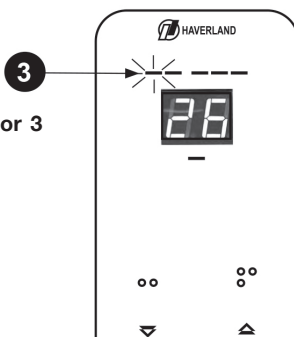

- 1) "Learning" mode: "slowly flashing" light.
- 2) Manual mode: light is OFF.
- 3) Sensor mode: fixed light.
- 4) "Forced" programming mode (via Smartbox App (available separately))



3. OPERATION

3.4.1 LEARNING MODE (factory activated):

During seven days and CONTINUALLY, week by week, your radiator will be learning your lifestyle.

The radiator has 2 working profiles:

* Economic Profile “PE” (Default factory settings)

This profile prioritizes the energy savings.

- 1 If there is detection:  **Comfort mode.**
- 2 If there is no detection:  **> 30 minutes = Economy mode.**
- 3 If there is no detection:  **> 12 hours = Anti-frost mode.**

* Comfort profile “PC”:

This profile prioritizes comfort and welfare.

- 1 If there is detection:  **Comfort mode.**
- 2 If there is no detection:  **> 30 minutes = Economy mode.**
- 3 If there is no detection:  **> 16 hours = Anti-frost mode.**

Day by day, the radiator is “learning” the presence (comfort) periods and the absence periods (economy).

After 7 days, the radiator will start working according to the programmed presence periods (comfort) and the absent periods (economy), depending on the chosen working profile.

The comfort periods in the following week will start before the programmed time so that the unit warms up before you enter the room.



The auto-programming period is continuous. The radiator updates according to your lifestyle variations, day by day, week by week.



3. OPERATION

3.4.2 SENSOR MODE

- 1 If there is detection:  **Comfort mode.**
- 2 If there is no detection:  **> 30 minutes = Economy mode.**



The radiator does NOT store any information on the memory.

3.4.3 MANUAL MODE

In this mode, you decide when you want Comfort temperature, Economy temperature or Anti-frost temperature.

When Manual mode is selected, you only have to choose Comfort, Anti-frost or Economy and the desired ambient temperature.

3.5 ADJUSTING THE TEMPERATURE

In order to change the Comfort and Economy temperatures the radiator must be in MANUAL mode (see point 3.4).

The factory-set temperatures are:

- 1) **COMFORT TEMPERATURE = 20 °C**
- 2) **ECONOMY TEMPERATURE = 16 °C**
- 3) **ANTI-FROST TEMPERATURE = 7 °C**



The anti-frost temperature (7 °C) cannot be changed.



3. OPERATION

3.6 COMFORT, ANTI- FROST AND ECONOMY TEMPERATURES

The radiator has three pre-adjusted temperatures.

The operating temperature is shown in colours light indicator 2:

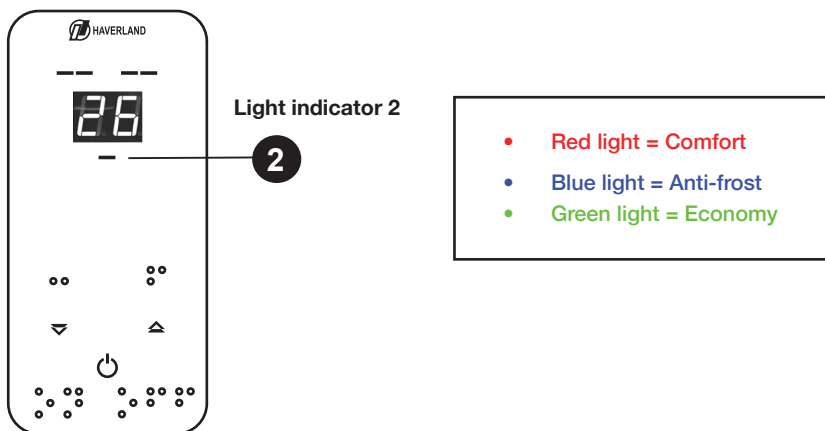

The default comfort temperature adjustment (when the room is occupied) is 20 °C.

The default economy temperature adjustment (when the room is not occupied or there's no detection on the room) is 16 °C.

The default anti-frost temperature adjustment (when the occupant is absent from the room for more than twelve hours) is 7 °C.

Comfort and economy temperatures can be modified (the anti-frost temperature is fixed):

1. To change the comfort and economy temperatures, the heater must be in MANUAL MODE (see point 3.4).

2. Select the temperature to be changed, comfort, anti-freezing or economy, pressing the  button .

- Red light = Comfort
- Blue light = Anti-frost
- Green light = Economy

3. Press the  button. The selected temperature will be displayed and it will start to flash.

4. To select the desired temperature please press the  or  buttons.



3. OPERATION



- The comfort temperature range is from 18 to 28 °C.
- The maximum economy temperature is 18 °C.
- The economy temperature can NEVER be higher than the comfort temperature.
- The economy temperature is always 4 °C less than the assigned comfort temperature.

3.7 “OPEN WINDOW” FUNCTION

This function is activated when there is a sudden drop of temperature in the room.





When this function is activated (indicator 11, point 3.1), the radiator will switch off, avoiding unnecessary power consumption.

By closing the window, the radiator will detect a rise in temperature and this function will be deactivated.

The radiator will switch on again to the mode it was on before the switch-off.



This function is pre-set from the factory. It can be activated or deactivated by the user.



1. Set the radiator on “Standby” mode by pressing the “Standby” button.
2. Press the  and  buttons simultaneously, two lines will be displayed indicating that the function is activated.
3. To deactivate the function please press again the  and  buttons.

A single line will be displayed. Wait a few seconds for the radiator to return to the “Standby” mode. If you wish to switch on the radiator, press the “standby”  button.



3. OPERATION

3.8 “KEYPAD LOCK” FUNCTION

The keypad may be blocked and unblocked by simultaneously pressing the  and  buttons.



The display and the control panel lights will turn off.

A dot will be displayed on the right bottom part of the display.



If **two dots are displayed** it means the keyboard is locked and the unit is on standby mode. Please unlock the keyboard first.

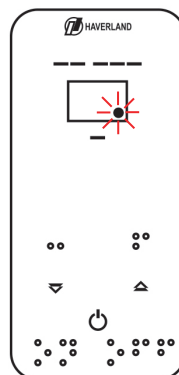

3.9 STANDBY

To switch the radiator on and off press .



ON = 1 beep.
OFF = 2 beeps.

A dot will be displayed on the left part of the display.

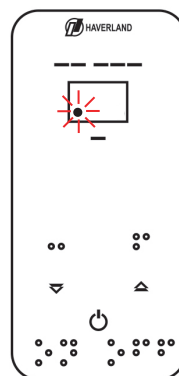



3. OPERATION

3.10 ADJUSTING DAY AND TIME

Your radiator is supplied with the clock and day of the week already factory set.

You will need to adjust the clock to change to the Summer/Winter schedule (this is an automatic setting if you have the Smartbox (not included)).



- 1** Press the  and  buttons. A “d” will appear on the screen.



Wait.

Then a number from 1 to 7 will appear flashing to indicate the day of the week.



Wait. Adjust the day of the week by pressing  or . Wait.



- 2** “h” is displayed.



Wait.

Then, the value indicating the hours will flash.



Adjust the hours using  and . Wait.

- 3** Then, “n” appears on the screen.





Wait.



3. OPERATION

Then, the value indicating the minutes will flash:



Adjust the minutes using  or 



Wait.

4

Straight away, the working profile will appear and show the learning mode "PE", "Economy Profile".

On the "Economy" PE, the energy savings is prioritized, while on the Comfort Profile "PC" it prioritizes your comfort.



To set up the profile using  or 

Wait.

Then, to finalise, the approximate room temperature appears.

3.11 OTHER INDICATIONS

3.11.1 Heating element ON indicator:

When the radiator is operating, mode light 6 will be on.

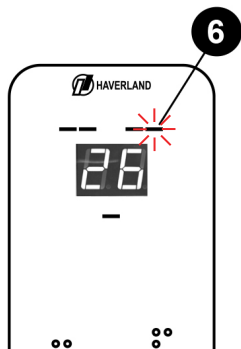

3.12.2 Sensor indicator On:

When the sensor is detecting, mode light 5 will be on.

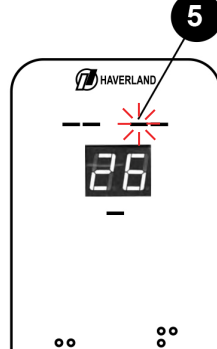



4. SMARTBOX

3.12 BATTERY

Your radiator is fitted with long-duration lithium battery.

When the battery is replaced, the day of the week and the time have to be re-adjusted (see point 3.10) (this is an automatic setting if you have the Smartbox (not included)).

4.1 SMARTBOX (OPTIONAL)



Thanks to the “smartbox” and our Haverland APP, you will have control of all functions of your radiators through your smartphone, tablet or PC/Mac.

Check with your distributor.

Voice Control



“Smartbox optional”



APP



Google is a trademark of Google LLC.



4. SMARTBOX

4.2 CONTROL “VIA APP”

To control all functions of your radiators, through your smartphone or tablet and via our free Haverland app, you will need a Haverland Smartbox (**not supplied with the device**).

Our Haverland Smartbox connects your radiators to the Internet using the property's router.



The Smartbox communicates with the radiators via radio frequency, and with the router through an Ethernet cable (supplied with the Smartbox).

If you would like to purchase our Haverland Smartbox, please contact your distributor.



4.2.1 HOW DO I CONFIGURE THE SMARTBOX WITH MY RADIATORS?

Once you have installed our Smartbox (follow the steps described in its manual), you can download our Haverland app  for free on the Apple Store or on Google Play. Follow the wizard on the app.

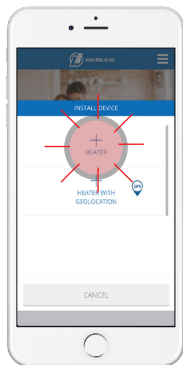
Once you have registered into our system (user account and your Smartbox is registered), press “+ HEATER”. The Smartbox is now in “discovery mode”.



Then to add the device to the app make sure the radiator is on “Standby” mode.

Press the “START SEARCH” button in the app and hold both  and  buttons for at least 3 seconds on your radiator. The device is now installed on your app.

You can manage all its functions from your smartphone or tablet.





5. MAINTENANCE



If you are an installer, you do not need to download our app to install your customer's equipment. To activate our Smartbox in "discovery" mode, press the button on the back of the Smartbox for 3 seconds (see image).

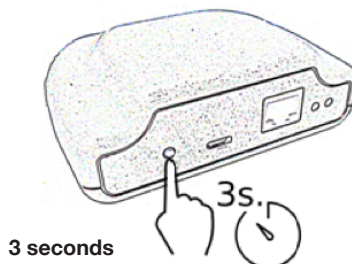

5. MAINTENANCE

Your radiator does not need any kind of special maintenance.

Just remove any dust with a soft dry cloth.

We recommend to start the winter season, by cleaning off the dust that has built up on the heater surface.



NEVER USE SOLVENTS OR ABRASIVE PRODUCTS.



6. GUARANTEE

MARSAN INDUSTRIAL, S.A. guarantees that the devices comply with the contracted specifications.

This warranty only covers the model of heater showed on the valid invoice.

Such rectifications will be guaranteed against any manufacturing and operating defect for the normal and domestic use of this product, for a period of 24 months as from the purchase date shown on the invoice.

HAVERLAND guarantees against material, design or manufacturing faults at the moment of its original acquisition for 2 years. The electronic component and paintwork / finish for 3 years and 10 years for radiator block seal (exclude accidental damage, transport, and misuse).

This warranty only covers the device whose model appears on the purchase invoice.

This warranty DOES NOT COVER incorrect installation, maintenance, cleaning or conserving the device, and neither does it cover failures and faults due to force majeure, chemical agents or atmospheric phenomena, incorrect use of the device, the purchaser's faulty electrical installations, transporting the device or problems caused by the device being handled by persons not authorised by MARSAN INDUSTRIAL, S.A.

This warranty must not be modified, altered or extended, and the Manufacturer does not authorise anybody to act on his behalf to modify, alter or extend it.

This warranty applies only to the Product.

To repair the device, the consumer must dial the Technical Assistance Service at 0330 3651940 or send an email to haverland@haverland.co.uk and ask for the information needed about the procedure to follow:

For a replacement, cancellation or price reduction, when in order, the consumer must go the establishment where the device was purchased. This warranty does not affect the consumers' rights as established in the provisions contained In Law 23/2003, the Consumer Goods Sales Guarantee Act.



Customer Service Telephone:

0330 3651940



E-mail: haverland@haverland.co.uk

Made in Spain

Haverland UK Limited
Challengue House
Sherwood Drive
Bletchley MK3 6DP

Marsan Industrial, S.A. reserves the right to modify without previous warning





Models	ECORAD500i	ECORAD750i	ECORAD1000i	ECORAD1250i	ECORAD1500i	ECORAD1800i
Heat output						
Nominal heat output (kW)	0.5	0.75	1.0	1.25	1.5	1.8
Maximum continuous heat output (kW)	0.5	0.75	1.0	1.25	1.5	1.8
Auxiliary electricity consumption						
At nominal heat output (kW)	0.5	0.75	1.0	1.25	1.5	1.8
At minimum heat output (kW)	0.5	0.75	1.0	1.25	1.5	1.8
In standby mode (kW)	< 0.001	< 0.001	< 0.001	< 0.001	< 0.001	< 0.001
Type of heat room temperature control	Electronic room temperature control plus week timer					
Other control options	<ul style="list-style-type: none"> - Room temperature control, with presence detection - Room temperature control, with open window detection - With distance control option - With adaptive start control - With working time limitation 					
Name of manufacturer	Marsan Industrial, S.A.					
Address	Avda. San Martín de Valdeiglesias, Km 2.2 28925 Alcorcón (Madrid) Spain					



Where you see this symbol on any of our electrical products or packaging, it indicates that the relevant electrical product should not be disposed of as general household waste in Europe. To ensure the correct waste treatment of the product, please dispose of it in accordance with any applicable local laws or requirements for disposal of electrical equipment. In so doing, you will help to conserve natural resources and improve standards of environmental protection in treatment and disposal of electrical waste.

ECORADi

	W	Nº 
ECORAD500i	500	4
ECORAD750i	750	6
ECORAD1000i	1000	8
ECORAD1250i	1250	10
ECORAD1500i	1500	12
ECORAD1800i	1800	12

230 V 50 Hz
CLASS I
IP X0

